



**Lane Transit District**

**SNOW & ICE DETOURS  
2011-12**

**In the event of inclement weather,  
visit [ltd.org](http://ltd.org) for up-to-the-minute information  
about snow and ice service adjustments and detours.**

## Accessible Operating Policies During Snow and Ice Conditions

**Bus Stops:** During snow and ice, bus operators may determine whether a bus stop is unsafe to stop or deploy the lift. Example: On steep, hilly, icy streets, it may be unsafe to stop the bus. If the stop is not clear of snow, customers with disabilities may wait for the bus at a cleared sidewalk or driveway near the bus stop.

**Snow Van Service:** The snow vans are not lift-equipped. LTD customers with disabilities living in snow van neighborhoods may use *RideSource* for transportation when LTD operates in snow and ice modes. If a customer with a mobility device wants to board the snow van and cannot, provide them with the *RideSource* telephone number. (See *RideSource* information below.)

**RideSource:** *RideSource* provides curb-to-curb, accessible transportation for customers who are unable to use LTD buses because of a disability. Typically during periods of extreme snow and ice the “path of travel” needed to get to and from a bus stop becomes inaccessible. LTD customers with disabilities who are unable to get to their bus stop because of the combined factors of snow and their disability (including those who live in areas served by LTD’s “snow van” service) can use *RideSource* during periods of extreme winter weather marked by snow and icy conditions. These riders are considered conditionally eligible under such circumstances.

*RideSource* operates a fleet of accessible buses and vans. *RideSource* may be able to pick up a customer at their home, or a nearby area cleared of snow, and will transport the customer to the nearest LTD transit station, where they can transfer to an LTD accessible bus. In some cases, providing the full trip to a destination may be necessary.

To request a ride, LTD customers should try to contact *RideSource* at least 24 hours in advance. Given the nature of winter weather, this isn’t always practical. Same-day requests during snow and ice are accommodated on a space-available basis.

Snow service information will be available on the LTD website for *RideSource* and for the Diamond Express which provides limited service to and from Oakridge, Monday through Friday only.

**RideSource:** 541-682-5566 7-1-1 TTY

**Diamond Express:** 541-782-1157 7-1-1 TTY

For current route information, call LTD Customer Service or listen to these radio stations:

KPNW 1120 AM KUGN 590 AM

KMGE 94.5 FM KLCC 89.7 FM

KXOR 660 AM KKNU 93.3 FM

LTD Customer Service Center: 541-687-5555 7-1-1 TTY

LTD Administrative Offices: 541-682-6100 7-1-1 TTY

*Note: Information contained in this packet is also available on the LTD website at ltd.org.*



REGULAR ROUTE: \_\_\_\_\_

Donald

SNOW DETOUR: \_\_\_\_\_

**Outbound:** Willamette, l. 29th, l. Amazon Parkway, Amazon Station, layover in Bay A, (T), until two minutes before inbound Willamette & 29th timepoint (**mandatory two-minute hold for Route 24 snow bus/van**).

**Inbound:** r. Amazon Station, 29th, r. Willamette, r. 24th, l. Amazon Parkway, l. 19th, r. Oak. Resume regular inbound routing and timepoints.

SNOW BUS/VAN ROUTING: ■■■■■■

This snow bus/van will miss bus stops on Pearl Street and 34th Place.

This Snow Bus/Van Routing is to run at least two trips per hour (depending on the zone). If you cannot maintain this schedule, notify Transit Operations.

**ZONE 1:** No snow bus/van is needed.

**ZONE 2:** Amazon Station, 29th, l. Willamette, l. 33rd, l. Donald (becomes Willamette), r. 29th, l. Amazon Parkway, r. Amazon Station, Bay D.

**ZONE 3:** Amazon Station, 29th, l. Willamette, l. Donald, r. 46th, r. Willamette, r. 40th, l. Donald. (This snow bus/van will miss bus stops on Pearl Street and 34th Place.) Becomes Willamette, r. 29th, l. Amazon Parkway, r. Amazon Station, Bay D.

NOT SERVED ON DETOUR: |||||

## 24 Donald

\_\_\_\_\_ Regular Route

\_\_\_\_\_ Snow Detour

■■■■■■ Snow Bus/Van Routing

||||| Not Served on Detour

(T) Transfer point at Amazon Station

(L) LTD Station

(P) LTD Park & Ride

Donald

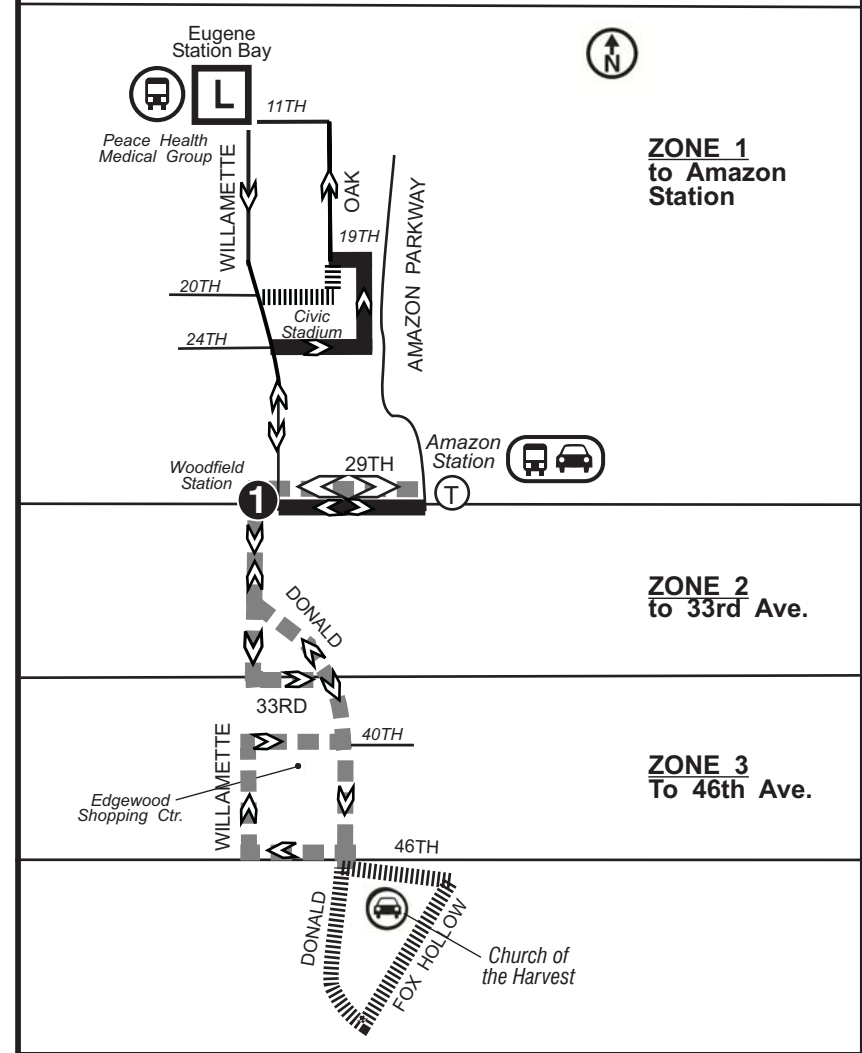

Q/SP&M/snow/graphics/11-12/snowroutes-textandmappages2011-12.fhd11



Fairmount



Fairmount

REGULAR ROUTING: \_\_\_\_\_

SNOW DETOUR: \_\_\_\_\_

Use this detour for the 08:40 and 15:40 trips:

19th . . . I. Orchard, r. 17th, I. Walnut, I. Franklin,  
I. Orchard, r. 19th. Resume regular routing.

LAUREL HILL SNOW DETOUR: \_\_\_\_\_

On trips that normally extend to Laurel Hill, customers should use the *Riverview at 16th* timepoint to catch the bus at the bus stop.

19th...I. Orchard, r. 17th, I. Walnut, r. Franklin, r. exit ramp to I-5 South, r. Riverview, I. at "Downtown" sign. Pick up or drop off customers at stop sign. L. at stop sign, I. onto off-ramp from I-5 to Franklin, Franklin, I. Orchard, r. 19th. Resume regular routing.

NOT SERVED ON DETOUR: |||||

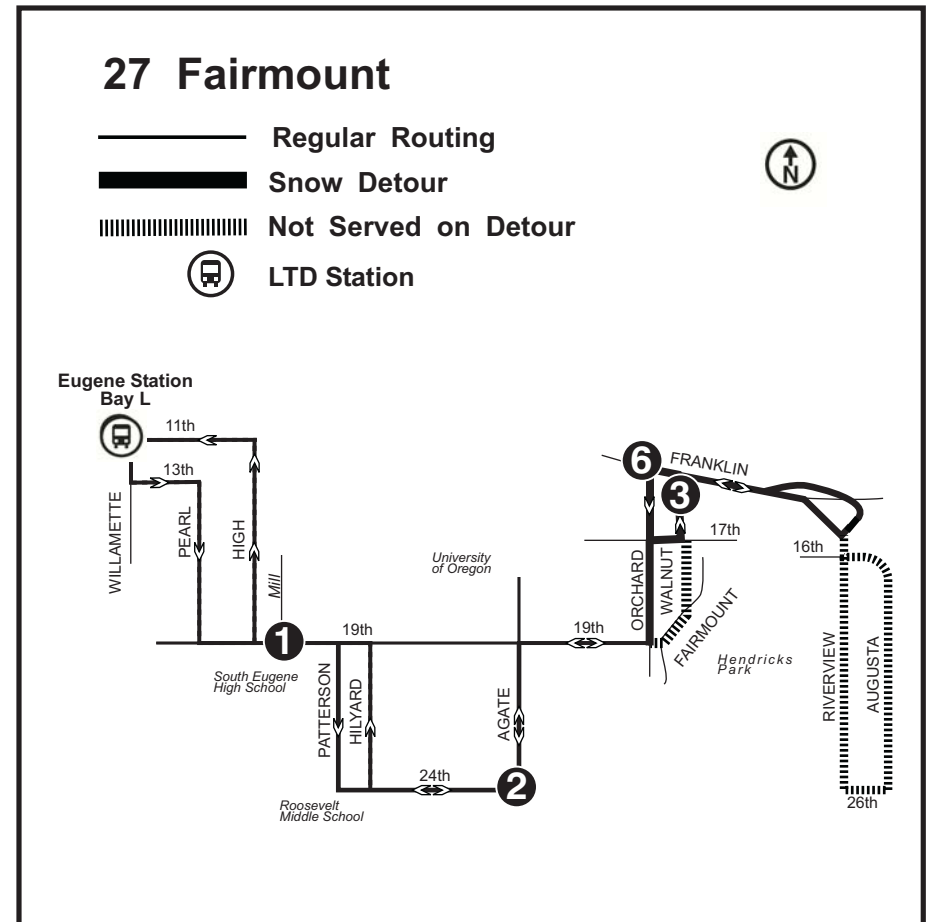

Q/SP&M/snow/graphics/11-12/snowroutes-textandmappages2011-12.fhd11



Jefferson



Jefferson

REGULAR ROUTING: \_\_\_\_\_

SNOW DETOUR: **—————**  
(WEEKDAYS AND WEEKENDS):

**Outbound:** Jefferson . . . r. 19th (Transfer point  $\text{\textcircled{T}}$  on 19th at Jefferson).

**Inbound:** Depart transfer point one minute after inbound timepoint for 19th and Jefferson (**mandatory two-minute hold for Route 33 snow bus/van**); 19th, r. Madison, r. 18th, l. Jefferson. Resume regular routing.

SNOW BUS/VAN ROUTING: **■ ■ ■ ■ ■**  
(WEEKDAYS AND WEEKENDS):

Leave transfer point (19th & Jefferson) one minute after Jefferson/19th outbound timepoint (**mandatory two-minute hold for transfers from outbound route 33**); r. Madison, r. 18th, r. Jefferson, r. 28th, r. Taylor, l. 26th, r. Fillmore, r. 24th, l. Jefferson, l. 19th, arrive transfer point  $\text{\textcircled{T}}$ .

NOT SERVED ON DETOUR: **|||||**

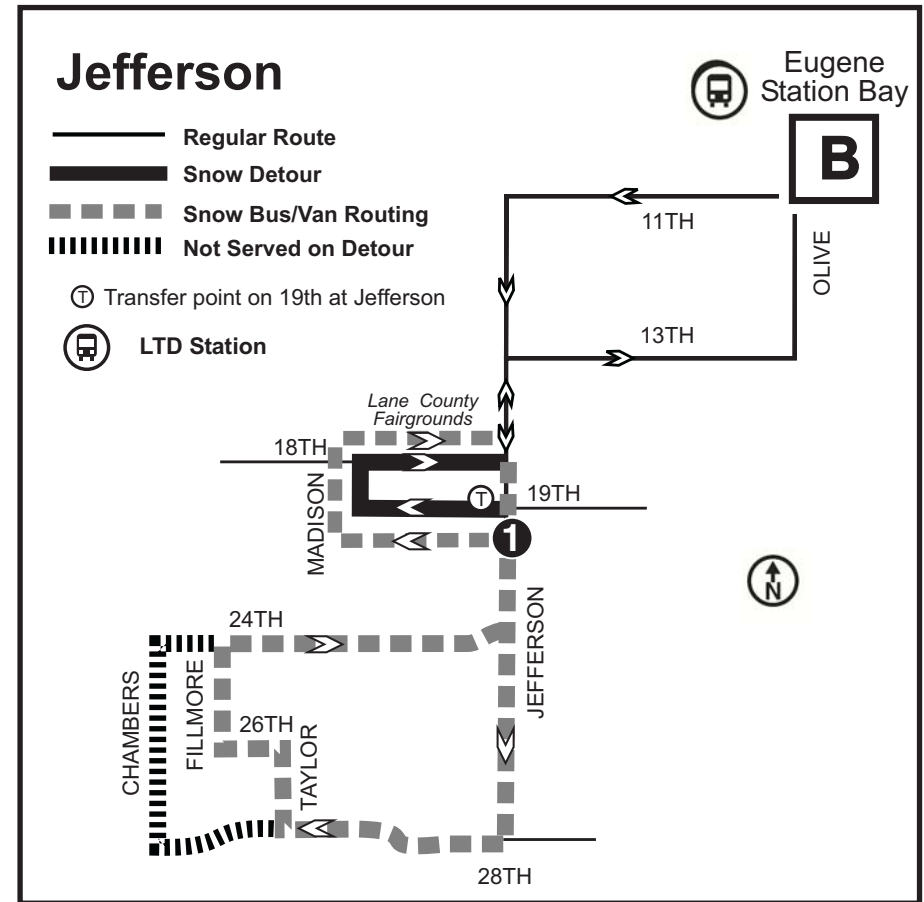

Q/SP&M/snow/graphics/11-12/snowroutes-textandmappages2011-12.fhd11



### UO/Willamette

#### REGULAR ROUTE: \_\_\_\_\_

Arrive Amazon Station, Bay D. Layover until scheduled inbound departure time (**mandatory two-minute hold for Route 73 snow bus/van**); resume regular weekday, evening, and weekend inbound routing and timepoints.

#### SNOW BUS/VAN ROUTING: ■■■■■■

This Snow Bus/Van Routing is to run with the same frequency as the 73.

If you cannot maintain this schedule, notify Transit Operations.

**ZONE 1:** No snow bus/van is needed.

**ZONE 2:** Amazon Station, 29th, l. Willamette, l. 33rd, l. Donald (becomes Willamette), r. 29th, l. Amazon Parkway, r. Amazon Station, Bay D.

**ZONE 3:** Amazon Station, 29th, l. Willamette, l. 40th, r. Donald, r. 46th, r. Willamette, r. 29th, l. Amazon Parkway, r. Amazon Station, Bay D.

#### NOT SERVED ON DETOUR: |||||



- Regular Route
- Snow Bus/Van Routing
- ||||| Not Served on Detour
- Ⓣ Transfer point on Amazon Station
- ⓁⓂ LTD Station
- ⓁⓂ LTD Park & Ride

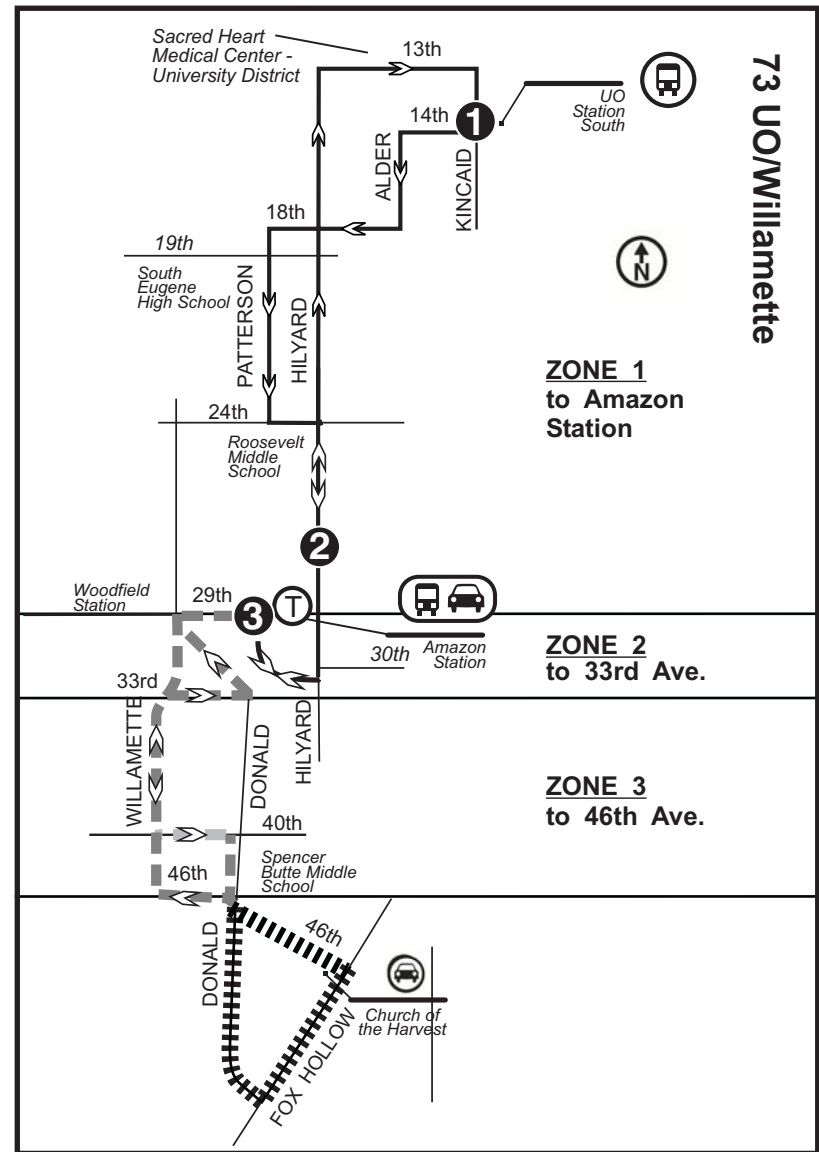

# 76

UO/Warren

**REGULAR ROUTING:** \_\_\_\_\_

**SNOW ROUTING:** ■■■■■■

**Outbound:**

11th . . . l. City View, r. 18th. Resume regular routing until you get to Bailey Hill.

Bailey Hill, l. Westleigh, r. first driveway into parking lot; immediate left after entering parking lot. Arrive transfer point (T) at Churchill Plaza.

**Inbound:**

Leave Churchill Plaza at Bailey Hill and 18th timepoint, l. Westleigh, r. Bailey Hill, r. 18th, l. City View, r. 11th. Resume regular route.

**SNOW BUS/VAN ROUTING:** ■■■■■■

**NOTE:** For the first trip (7:19), bus/van deadheads from the shop at 6:40 and starts at Wilshire & Warren.

Lv. Churchill Plaza two minutes before the Wilshire/ Warren timepoint: l. Westleigh, l. Bailey Hill, l. Warren, l. Wilshire, l. Windsor Circle East, r. Brittany, l. Kevington, r. Warren, r. Bailey Hill, r. second driveway into Churchill Plaza; immediate left to north-end parking lot (between the two driveways).

**NOT SERVED ON DETOUR:** |||

# 76

76 UO/Warren

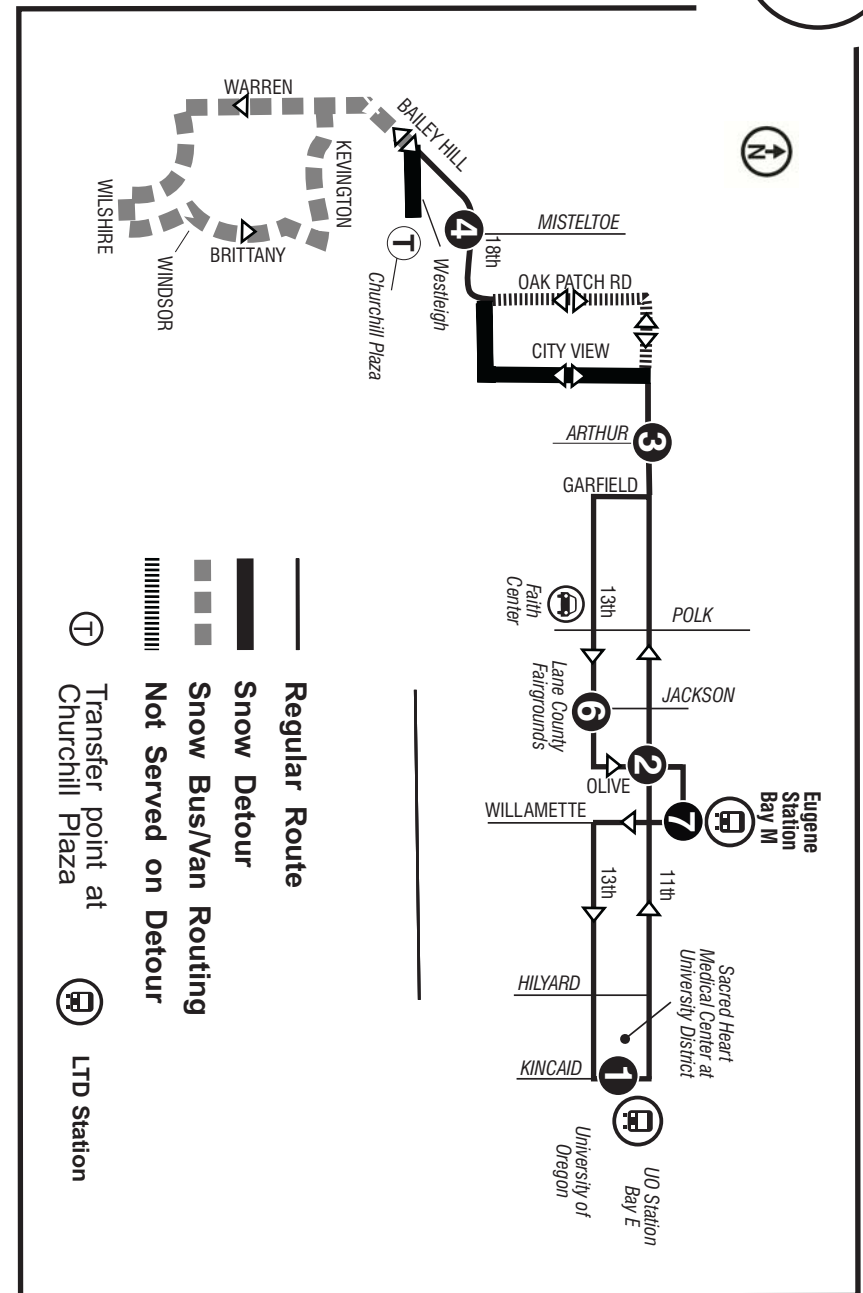

REGULAR ROUTE: \_\_\_\_\_

SNOW DETOUR: \_\_\_\_\_

Harris . . . r. 28th, I. Hilyard, I. 30th, I. Harris; layover at inbound bus stop on Harris and 30th until inbound timepoint; resume regular routing. **Upon arrival at UO, proceed to next departure location.**



NOT SERVED ON DETOUR: .....

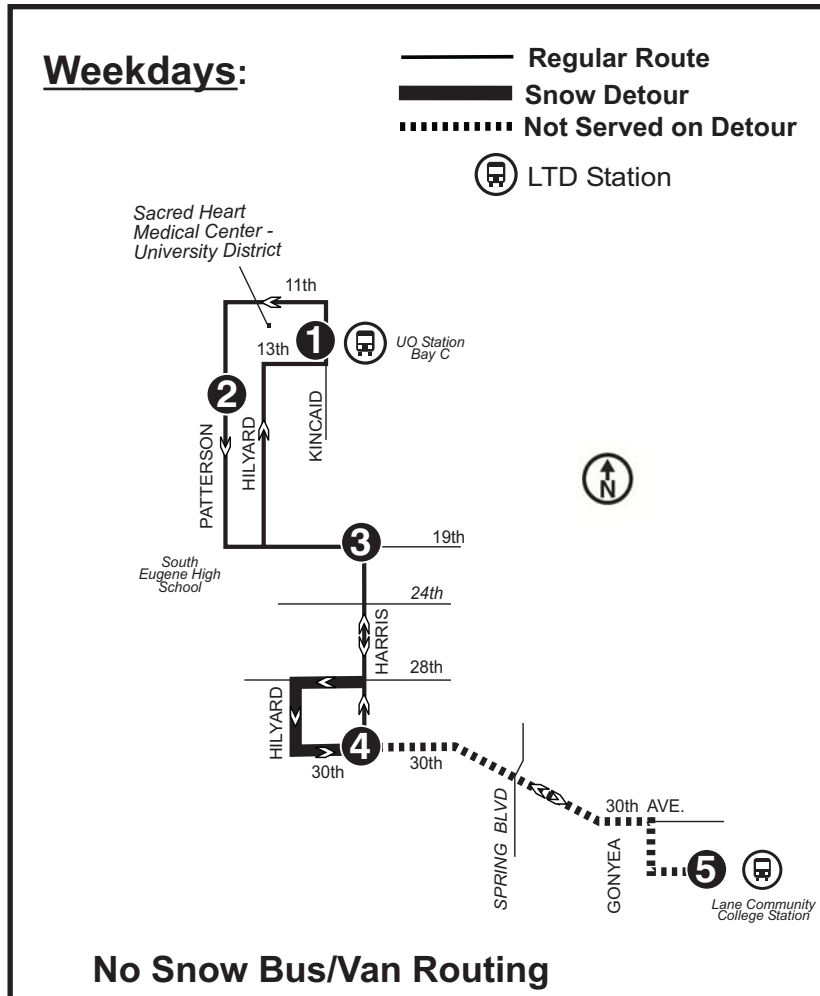

REGULAR ROUTE: \_\_\_\_\_

SNOW ROUTE: \_\_\_\_\_

Harris . . . r. 28th, I. Hilyard, I. 30th, I. Harris; layover at inbound bus stop on Harris and 30th until inbound timepoint; resume regular routing.



LCC/HARRIS

NOT SERVED ON DETOUR: .....

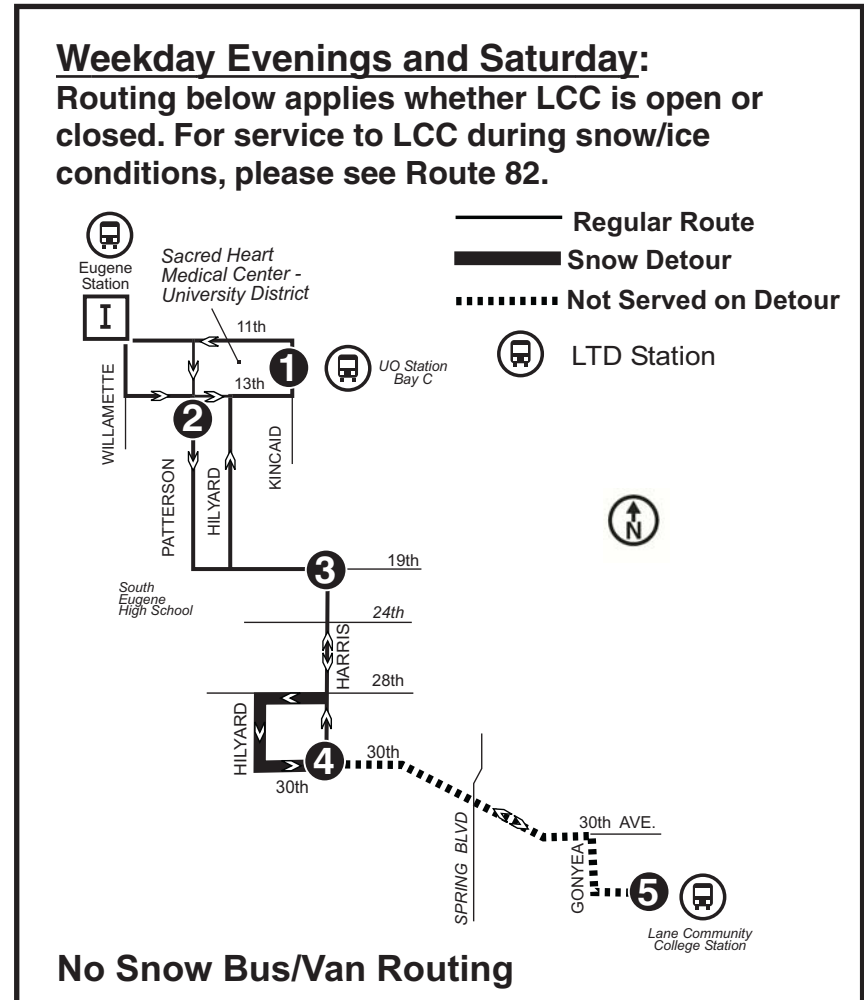



LCC/Pearl



LCC/Pearl

**SNOW DETOUR: ———**

**Outbound:**

I. Willamette, r. 10th., I. High, r. E. Broadway, Franklin Blvd., r. Old Franklin, McVay, r. 30th, r. LCC exit, Gonyea, I. LCC.

**Inbound:**

I. Dale Parnell Loop, r. Gonyea, r. 30th, I. McVay, Old Franklin, I. Franklin, I. 11th. Resume regular routing.

**IF LCC IS CLOSED:**

**Layover at 10th & Lincoln bus stop and then proceed to next route departure location at appropriate time.**

**NOT SERVED ON DETOUR: .....**

If LCC is open later than route 82 operates and we are still on detour, an extra board operator will drive the #82 snow detour route for the 19:50, 20:45, and 21:45 #81 trips that would have been in service if we were not on snow detour.

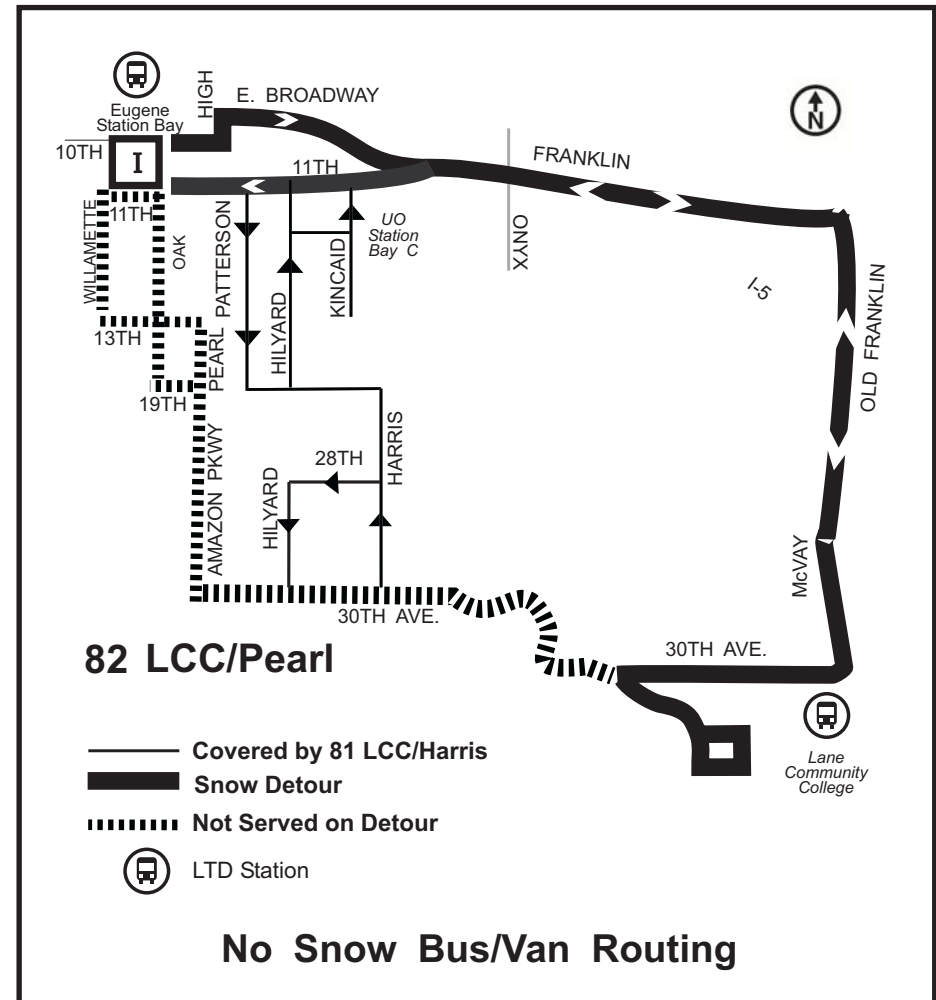

Q/SP&M/snow/graphics/11-12/snowroutes-textandmappages2011-12.fhd11

**SERVICE WILL NOT OPERATE WHEN LCC IS CLOSED.**



LCC/Springfield

REGULAR ROUTING:

SNOW DETOUR:

When LCC is open: No change to regular routing.

When LCC is closed, detour as follows:

Old Franklin . . . r. 19th (just past railroad trestle),  
I. Nugget Way (first paved road to the left--unsigned),  
layover (to the right of the road, just before Old Franklin)  
until :02/:32, I. Old Franklin. Resume regular Route 85  
inbound routing back to Springfield Station.

NOT SERVED ON DETOUR:



LCC/Springfield

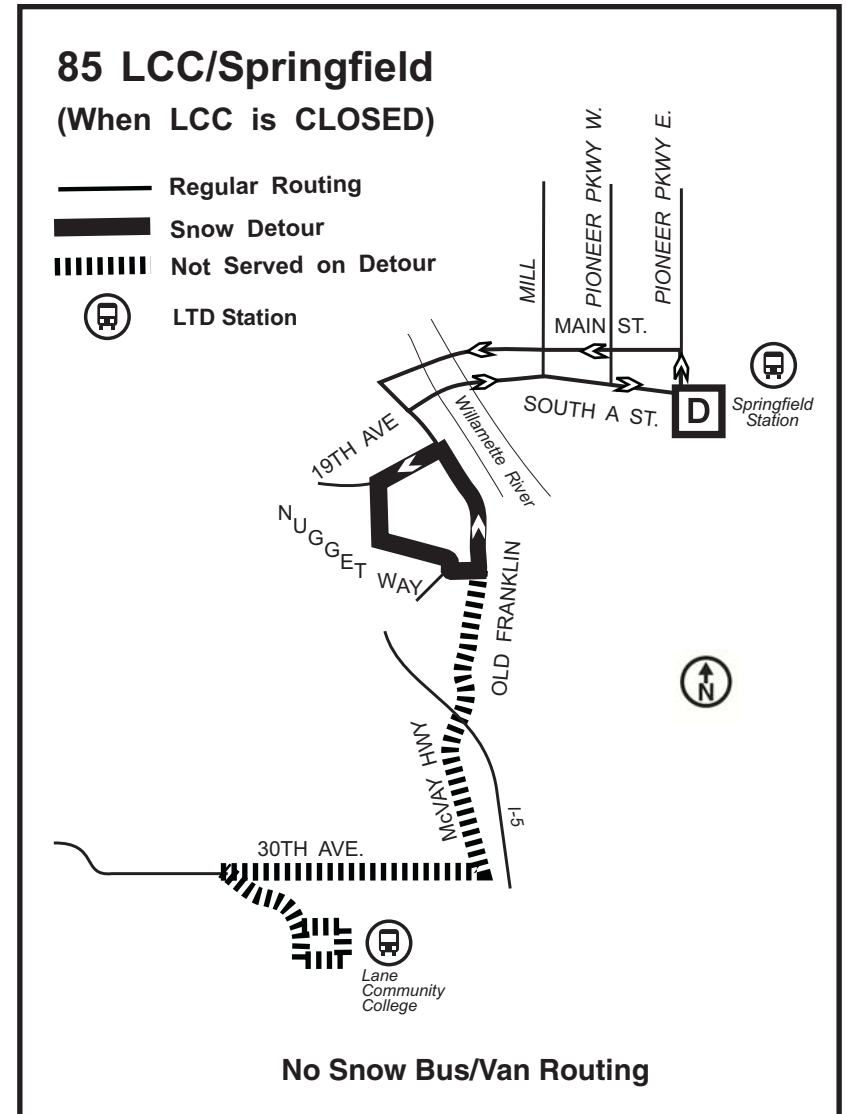

Q/SP&M/snow/graphics/10-11/snowroutes-textandmappages2010-11.fhd11



## McKenzie Bridge

**REGULAR ROUTING:** ———

Use normal outbound and inbound routing to/from Thurston Station.

**SNOW DETOUR:** ■■■■■■

**Policy:** Proceed as far as safety permits up Hwy 126. Use caution when turning around. Pick up appropriate inbound timepoint after turning around.

### Possible Options:

1. Hwy 126 . . . I. Taylor Rd. (just east of Milepost 50), r. Hwy 126; resume inbound timepoint at McKenzie Bridge.
2. Reverse loop through Blue River; turn left on Hwy 126 to continue outbound.
3. Reverse loop through Blue River; layover until inbound Blue River timepoint. Resume regular routing.
4. No service on McKenzie River Drive.

**Notify Transit Operations of your choice (541-682-6199).**

**NOT SERVED ON DETOUR:** ■■■■■■



## McKenzie Bridge

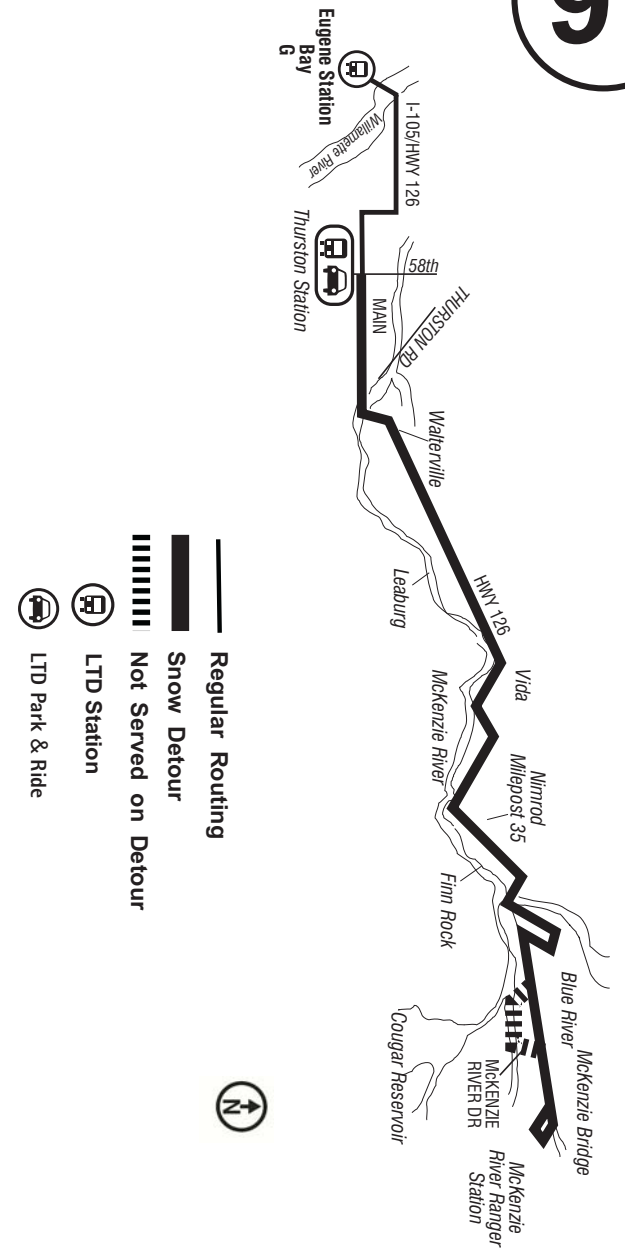

**No Snow Bus/Van Routing**

Q/SP&M/snow/graphics/11-12/snowroutes-textandmappages2011-12.fhd11



### Lowell/LCC - LCC OPEN



### Lowell/LCC - LCC OPEN

**REGULAR ROUTING:** ———

**SNOW DETOUR:** ———

**When LCC is open, detour as follows:**

**Outbound:**

l. Willamette, r. 10th., l. High, r. E. Broadway, Franklin Blvd., r. Old Franklin, r. 30th Ave., r. LCC exit, Gonyea, LCC. Resume regular routing.

**Inbound:**

LCC... r. Gonyea, r. 30th Ave, cross overpass, l. Old Franklin, l. Franklin, l. 11th. Resume regular routing.

**NOT SERVED ON DETOUR:** |||||

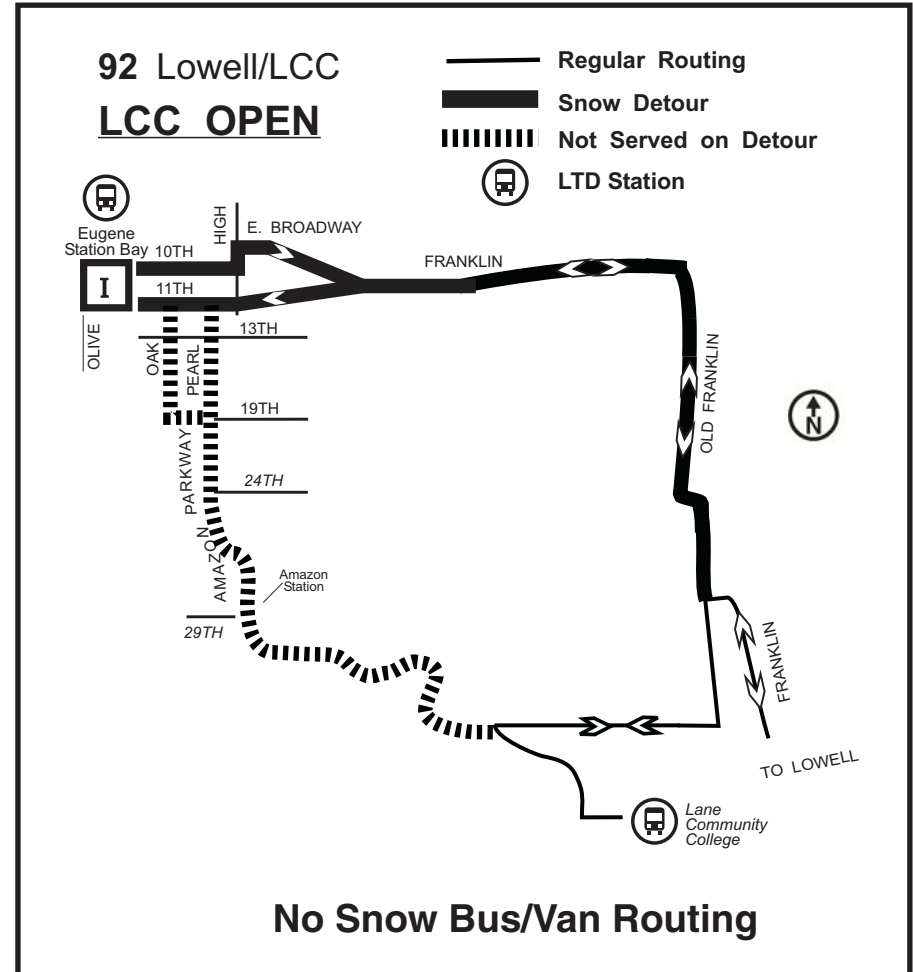

Q/SP&M/snow/graphics/11-12/snowroutes-textandmappages2011-12.fhd11



### Lowell/LCC - LCC CLOSED

**REGULAR ROUTING:** ———

**SNOW DETOURS:** ———

**When LCC is closed, detour as follows:**

**Outbound:**

l. Willamette, r. 10th, l. High, r. E. Broadway, Franklin, r. Old Franklin, l. Franklin (to Buford Park). Resume regular routing.

**Inbound:**

. . . Franklin, r. Old Franklin, l. Franklin Blvd., l. 11th. Resume regular route.

**NOT SERVED ON DETOUR:** |||||



### Lowell/LCC - LCC CLOSED

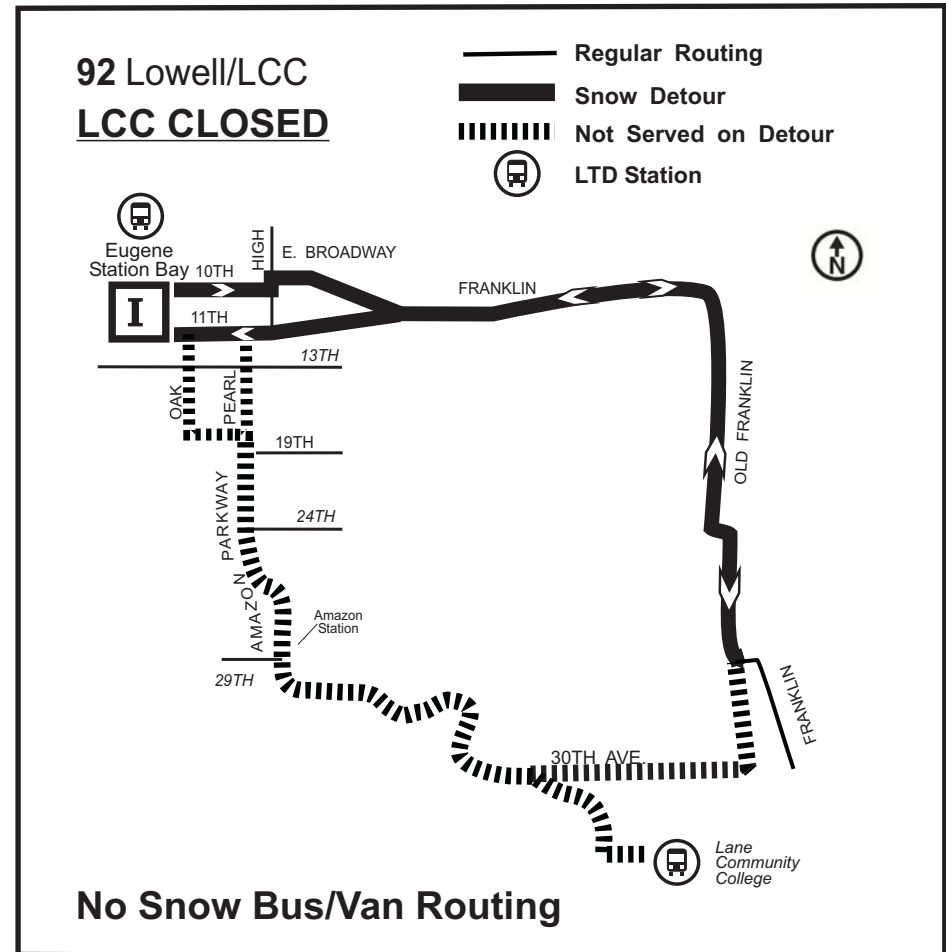

Q/SP&M/snow/graphics/11-12/snowroutes-textandmappages2011-12.fhd11



## COTTAGE GROVE

### REGULAR ROUTING: \_\_\_\_\_

If LCC is OPEN, follow regular route variations for LCC as listed in individual schedules.

If LCC is CLOSED, disregard LCC route variations listed in individual schedules and follow regular routing in tree book.

### SNOW DETOUR IN COTTAGE GROVE - \_\_\_\_\_

#### Outbound AM and Weekends:

. . . I-5 South, r. exit 174 to Cottage Grove (DO NOT bear right on exit ramp). Go straight through intersection at traffic signal; becomes Gateway Blvd., r. Main, l. Hwy. 99. Resume regular routing. . . . Main Street eastbound, l. Gateway Blvd., r. Cottage Grove Connector (first traffic signal - to Row River Road); becomes Row River Road, r. Thornton, r. Thomas, r. perimeter road to Wal-Mart stop.

#### SNOW DETOUR - Outbound PM:

Leave Wal-Mart bus stop on outbound leg of trip; l. Row River Road; becomes Collate Grove Connector, l. Gateway Blvd., r. Main, l. Hwy. 99. Resume regular routing. . . . Main Street eastbound, l. Gateway Blvd., r. Cottage Grove Connector (first traffic signal - to Row River Road); becomes Row River Road, r. Thornton, r. Thomas, r. perimeter road to Wal-Mart stop.

### NOT SERVED ON DETOUR: |||||



## COTTAGE GROVE

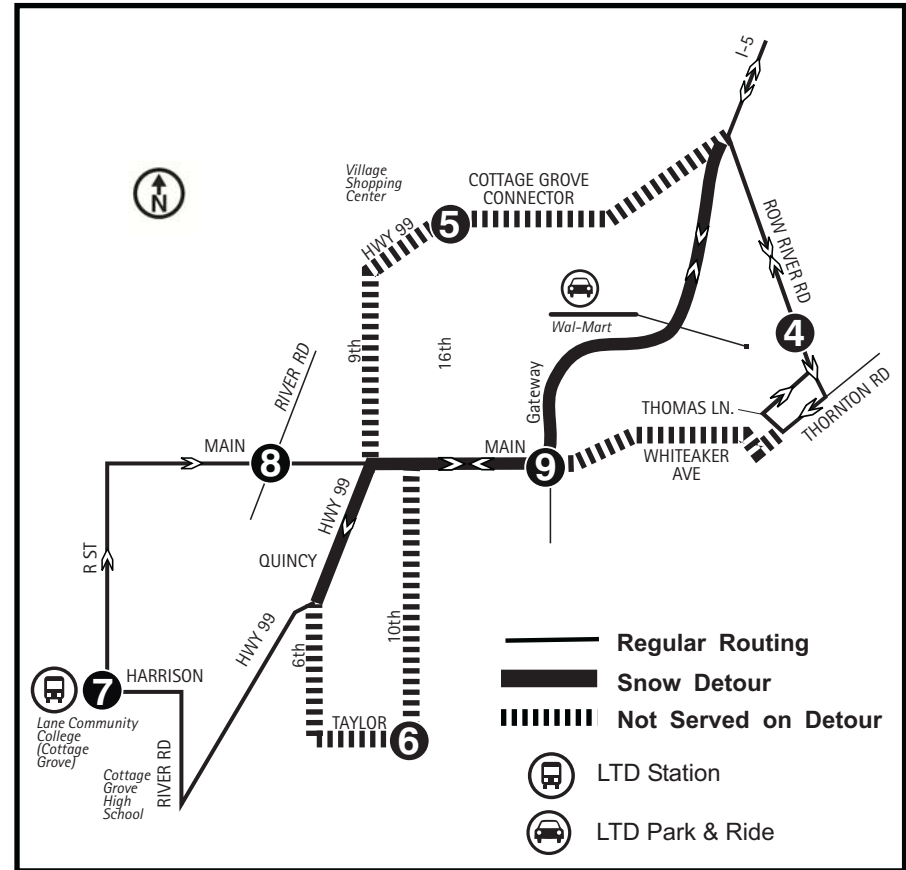

Q/SP&M/snow/graphics/11-12/snowroutes-textandmappages2011-12.fhd1



If an EmX station is closed, use mixed-use traffic lanes and alternative stops shown below.

